

SOLAR ANALYSIS AND ENVELOPE SCENARIOS

EXISTING

60 Bay St	8/19	42.1%
56 Bay St	21/28	75%
Total	29/47	59.1%

 Apartments receiving 2 hours sun
June 21 8am - 3pm.

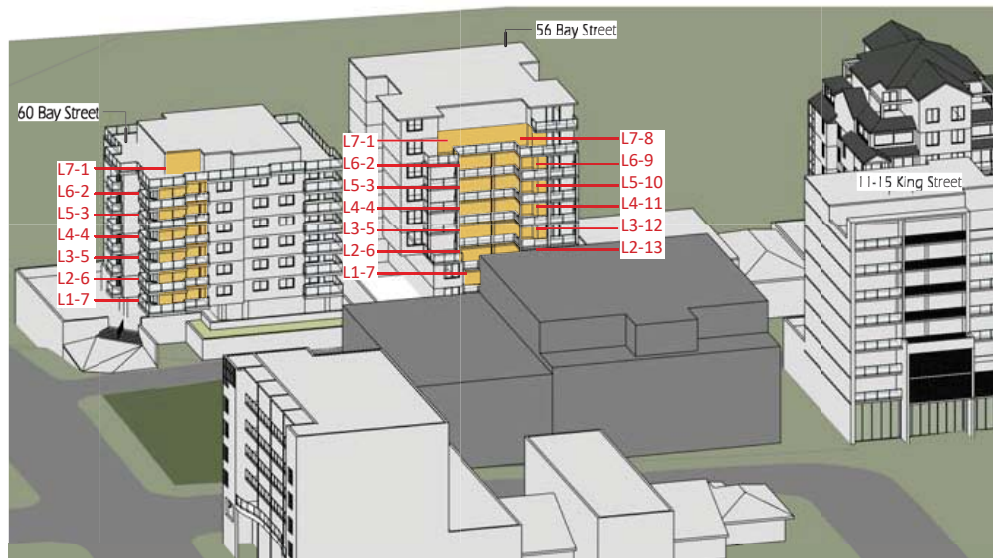

VIEW FROM THE SUN - 22 JUNE 9AM



VIEW FROM THE SUN - 22 JUNE 10AM

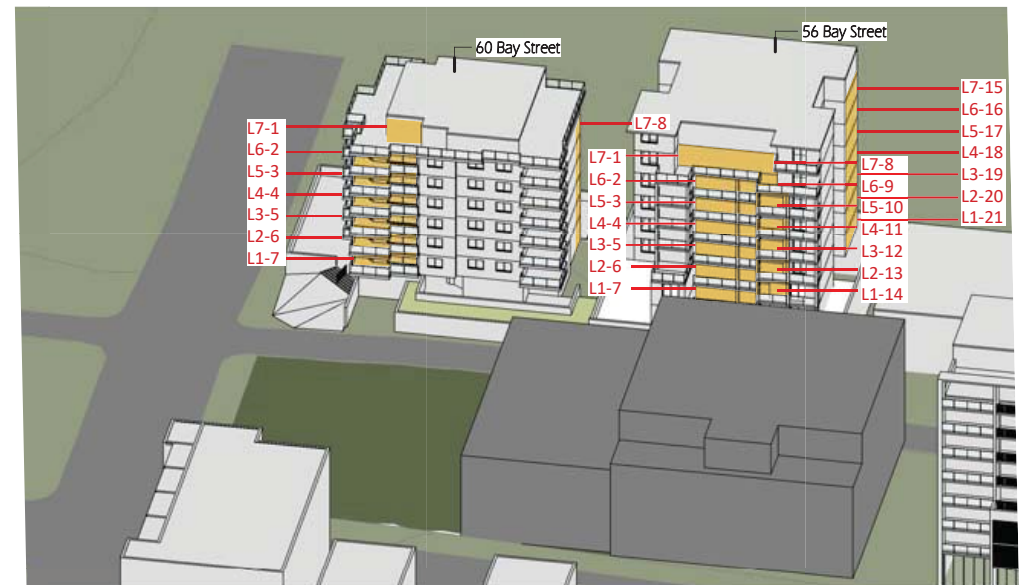

VIEW FROM THE SUN - 22 JUNE 11AM

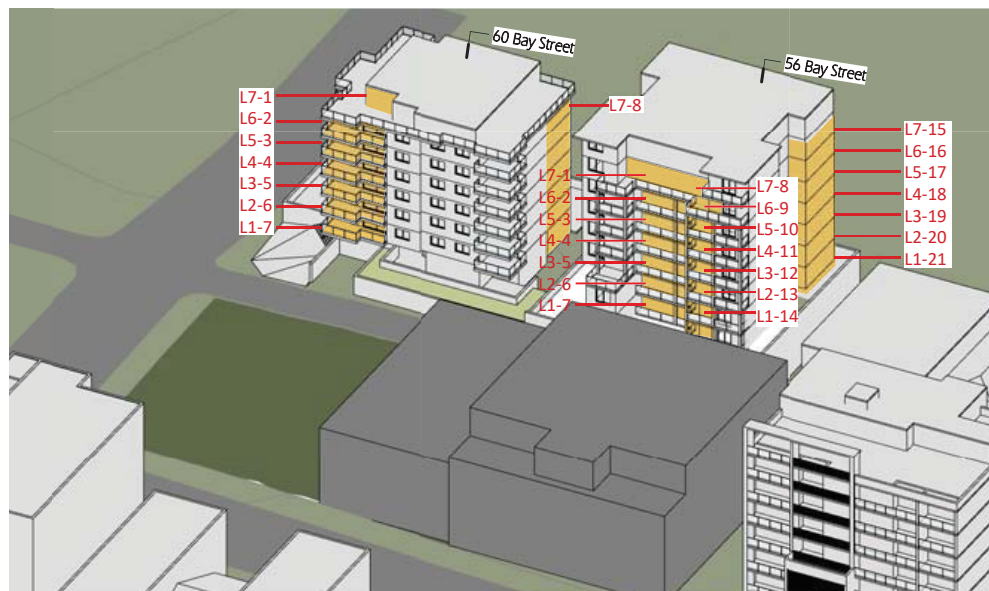

VIEW FROM THE SUN - 22 JUNE 12PM

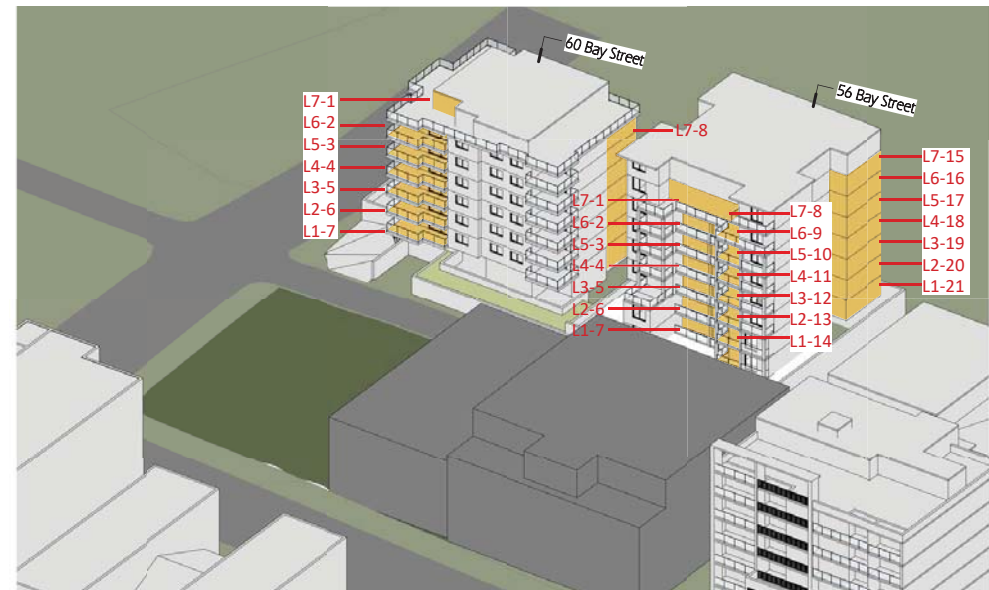

VIEW FROM THE SUN - 22 JUNE 12:30PM

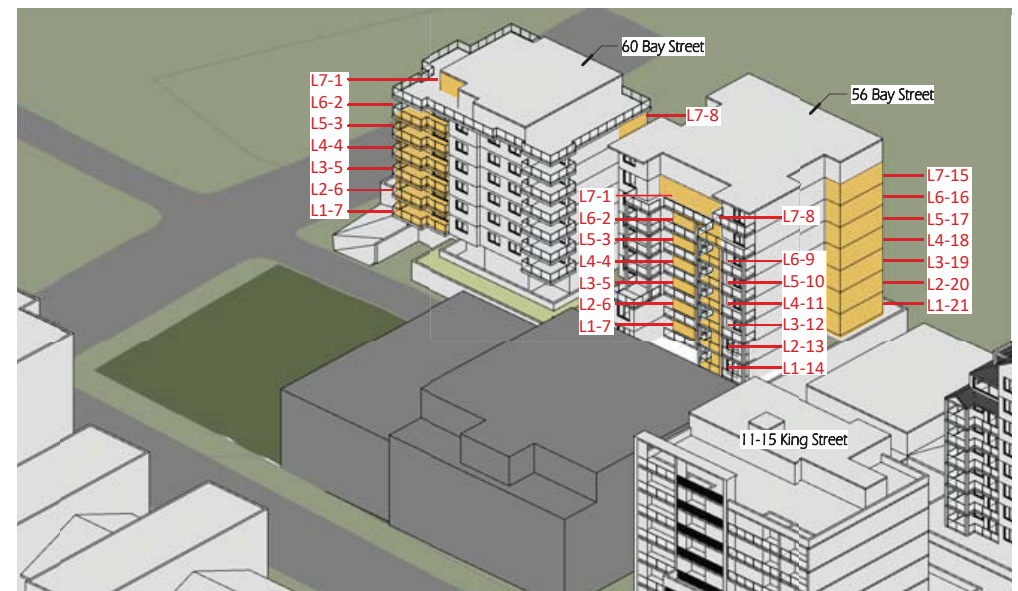

VIEW FROM THE SUN - 22 JUNE 1PM

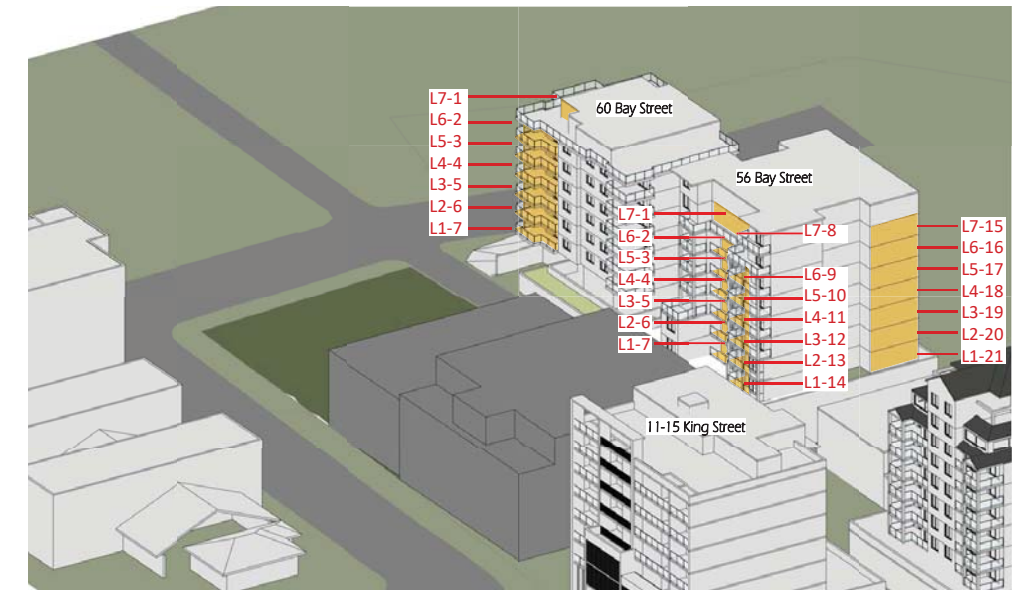

VIEW FROM THE SUN - 22 JUNE 2PM

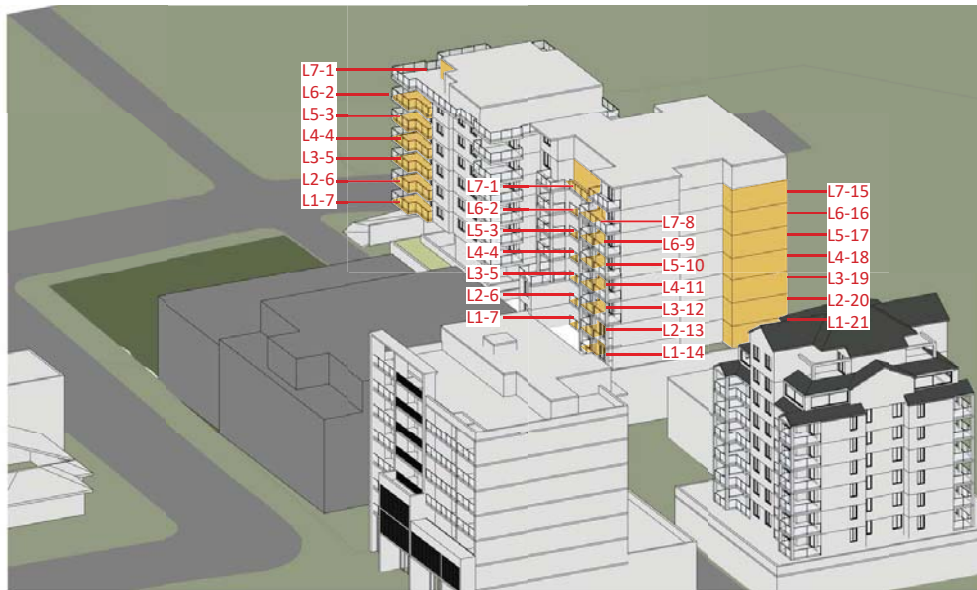

VIEW FROM THE SUN - 22 JUNE 2:30PM

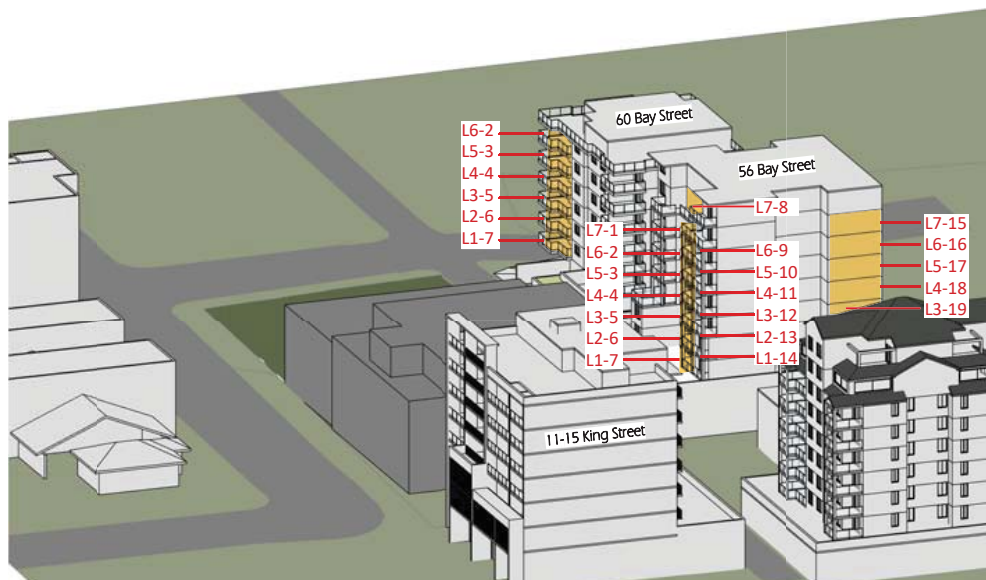

VIEW FROM THE SUN - 22 JUNE 3PM

SOLAR ANALYSIS AND ENVELOPE SCENARIOS

PROPOSED

60 Bay St	4/19	67.8%
56 Bay St	19/28	21%
Total	23/47	48.9%

Overall reduction of solar apartments 56-60 Bay St combined:

EXISTING	PROPOSED	REDUCTION
29/47	23/47	
61.7%	48.9%	12.8%

Apartments receiving 2 hours sun
June 21 8am - 3pm.

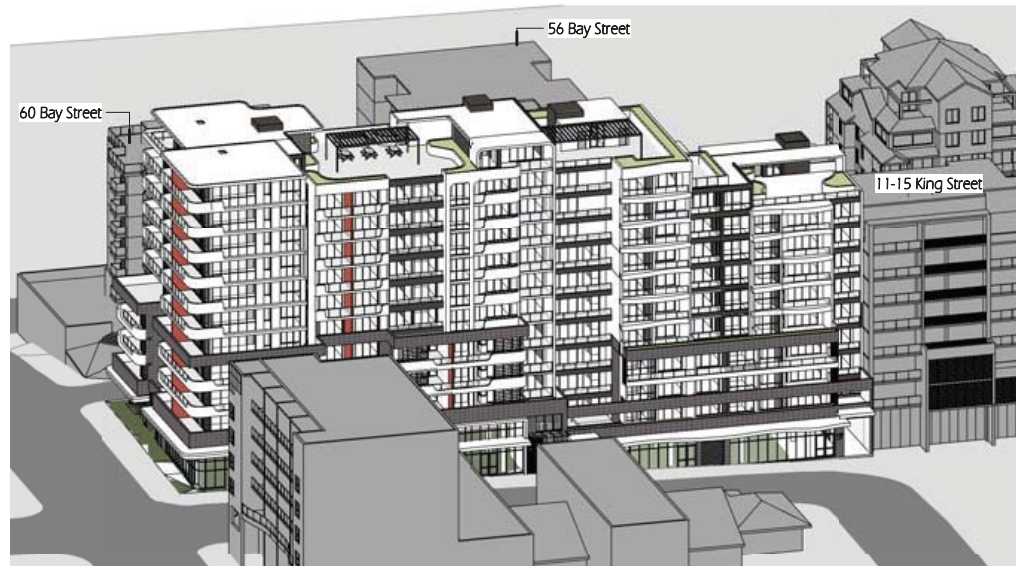

VIEW FROM THE SUN - 22 JUNE 9AM



VIEW FROM THE SUN - 22 JUNE 10AM

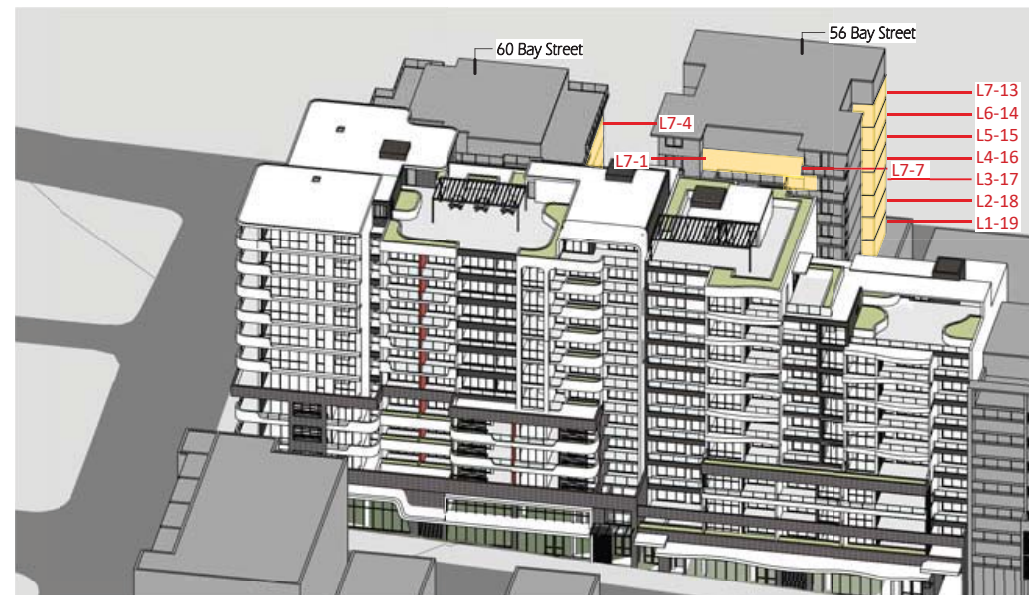

VIEW FROM THE SUN - 22 JUNE 11AM

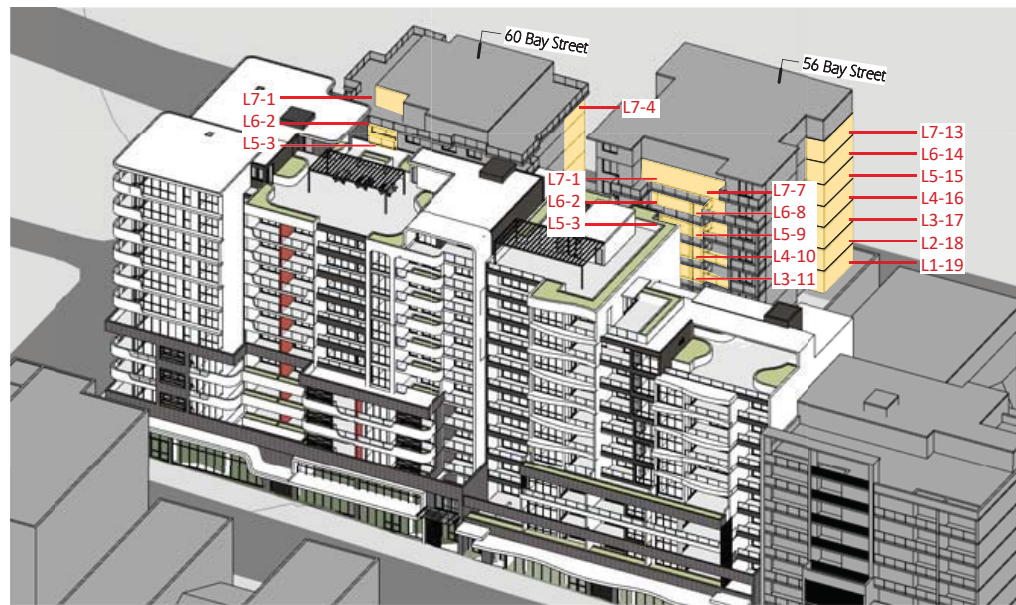

VIEW FROM THE SUN - 22 JUNE 12PM

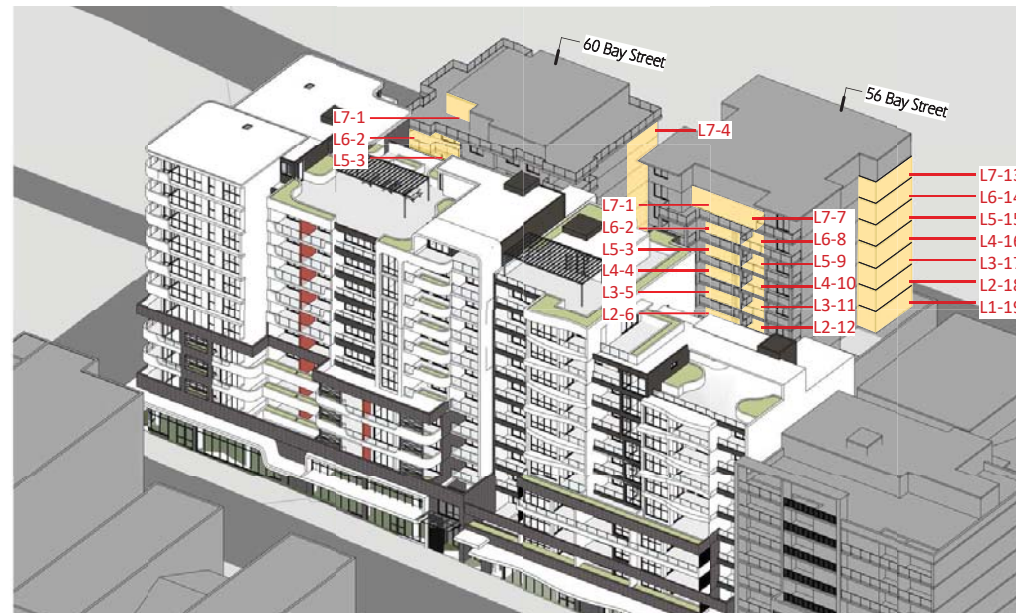

VIEW FROM THE SUN - 22 JUNE 12:30PM

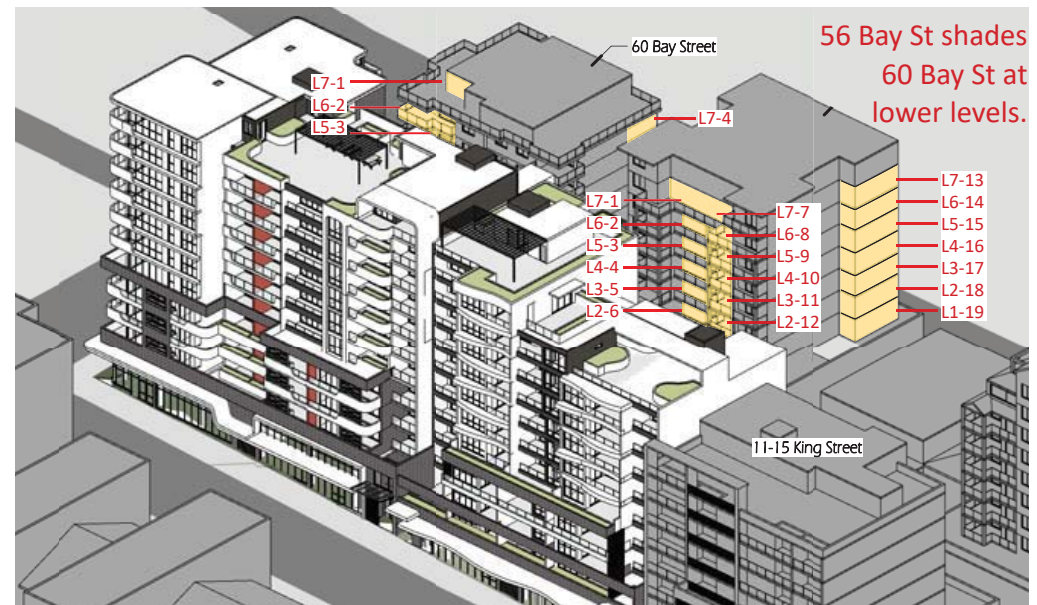

VIEW FROM THE SUN - 22 JUNE 1PM

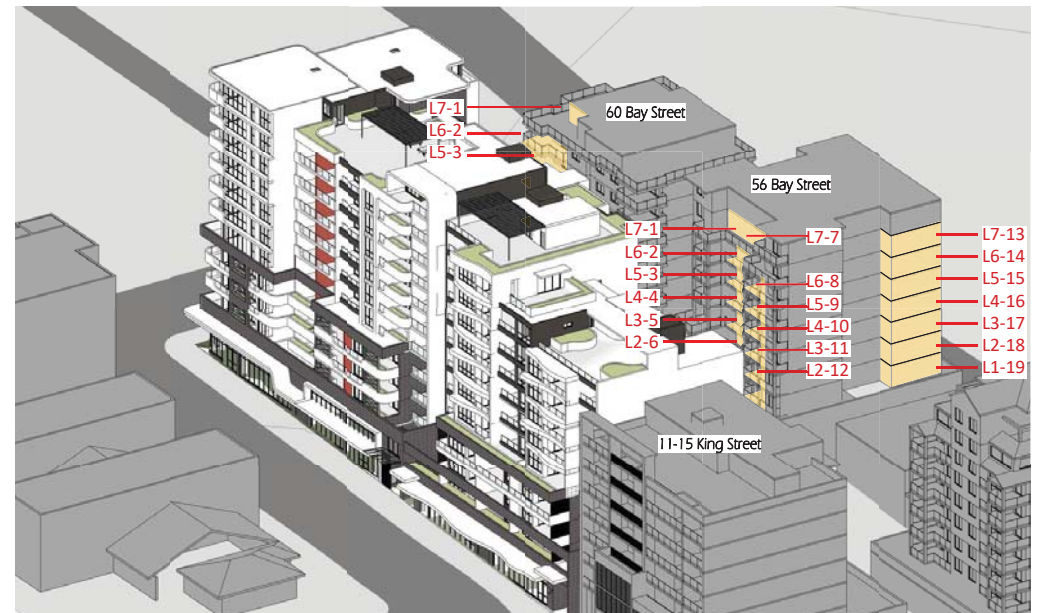

VIEW FROM THE SUN - 22 JUNE 2PM

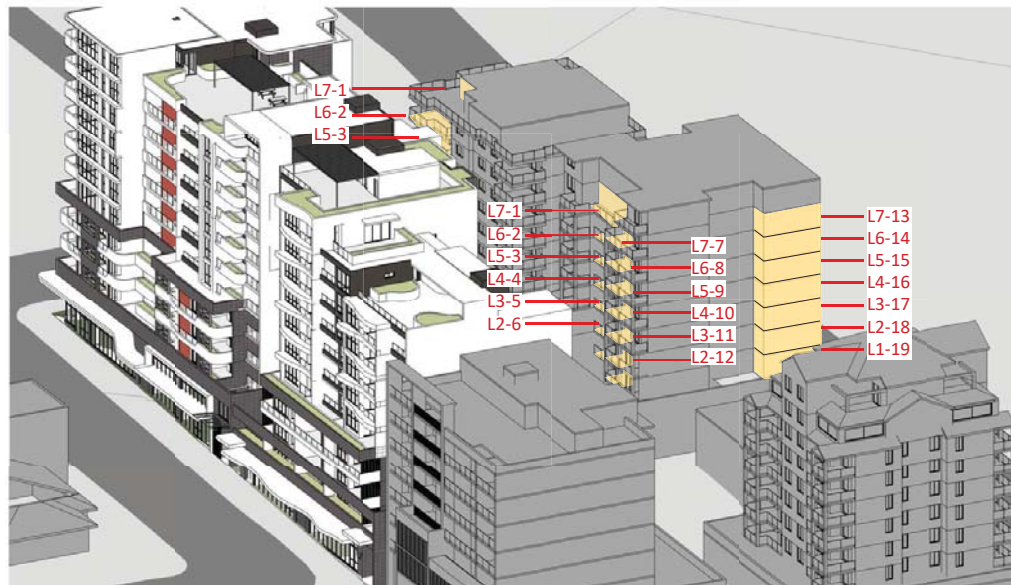

VIEW FROM THE SUN - 22 JUNE 2:30PM

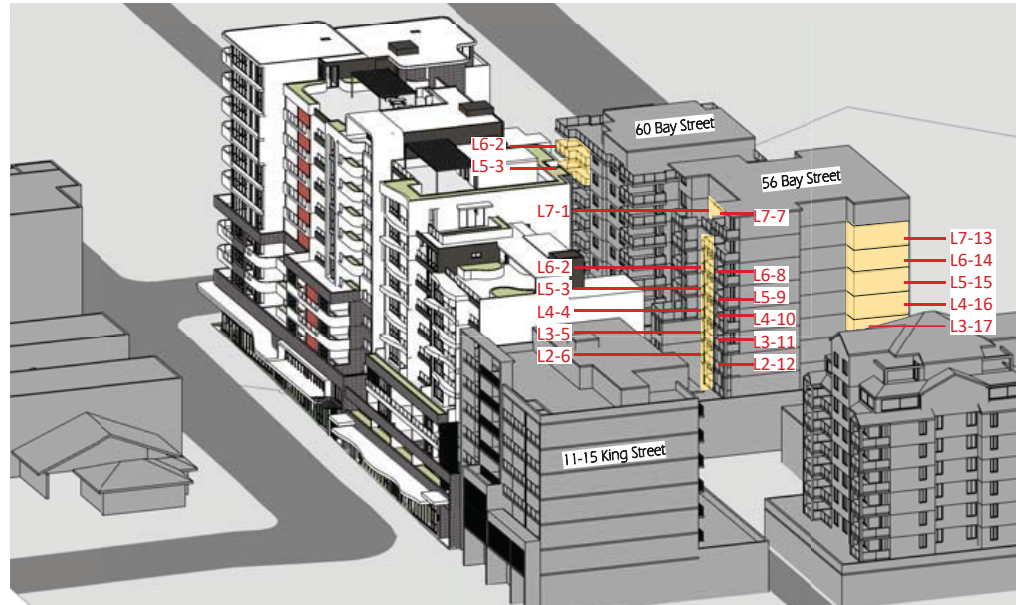

VIEW FROM THE SUN - 22 JUNE 3PM